

EAT

European Audio Team

INSTRUCTIONS FOR USE

EAT C-Sharp

Dear Music Lover,

Welcome! Congratulations on your purchase of our EAT C-Sharp turntable. Your EAT C-Sharp was hand-crafted by our team of skilled technicians. It has been tested rigorously and is ready for your enjoyment.

Please take the time to read this manual carefully to ensure that you obtain the ultimate performance from your EAT C-Sharp turntable. The tips contained within will ensure that your C-Sharp will remain as-new condition for many years to come!

Your contribution to environmental protection.

Disposal of packaging material:

Packaging protects the device from damage during the transportation. The packaging materials were chosen with the regards to the environmental protection and they are therefore recyclable.

Disposal of old equipment:

For the disposal of old equipment use a junk place appointed for that purpose.

The device is shipped partially disassembled in order to avoid damage to sensitive parts. Please, double-check immediately after receiving it if the packaging and the device were not damaged during the transportation.

If damaged please do not operate.



Warning of a hazard for the user, the unit or possible misuse.

Contents

Describing pictures, part list	4-5
--------------------------------	-----

Set-up

1. Transport screws	5
2. Protective covers, sub-platter and drive belt instalation	5-6
3. Platter instalation	7-8
4. Tonearm assembly	8
a) Cartridge assembly	9
b) Counterweight assembly	9-10
c) Vertica tracking Force setting (VTF)	10-11
d) Tonearm output connection	11
e) Vertical Tracking Angle setting (VTA)	12
f) Azimuth setting	12-13
g) Anti-skatin assembly and adjustment	14-16
5. Turntable plane position	16
6. Starting the motor, changing the speed	17
Technical specifications	18
Waranty, service, troubleshooting	19

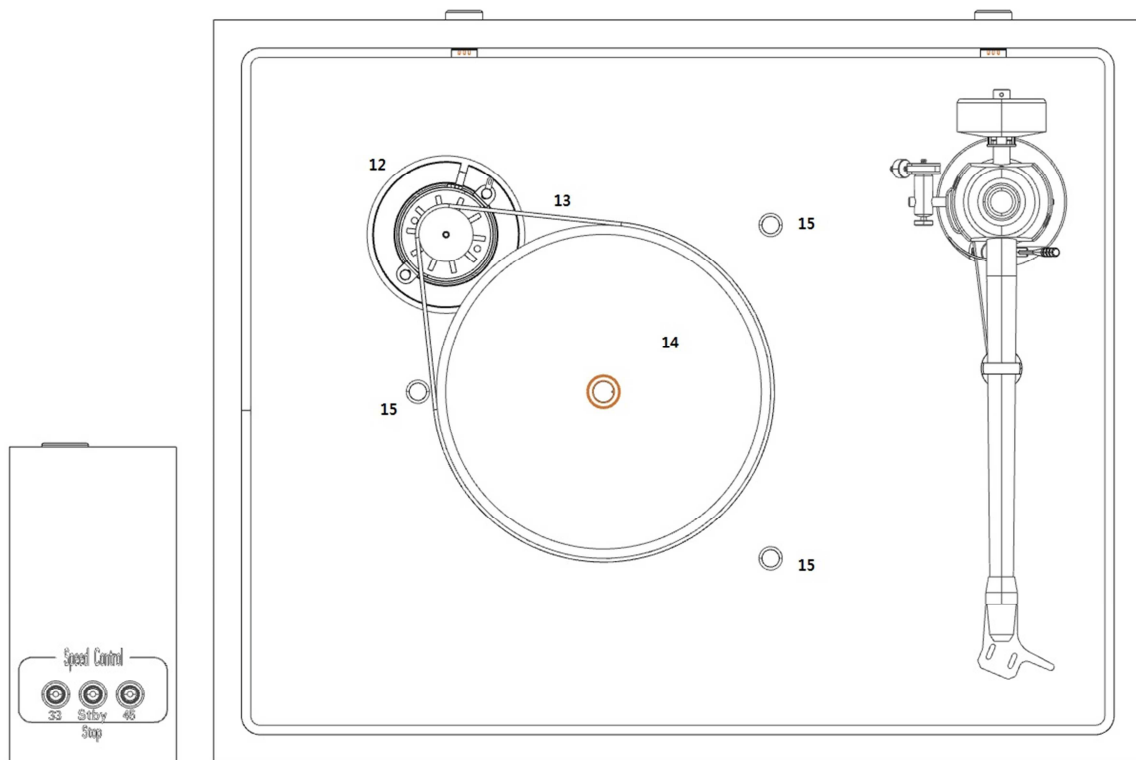
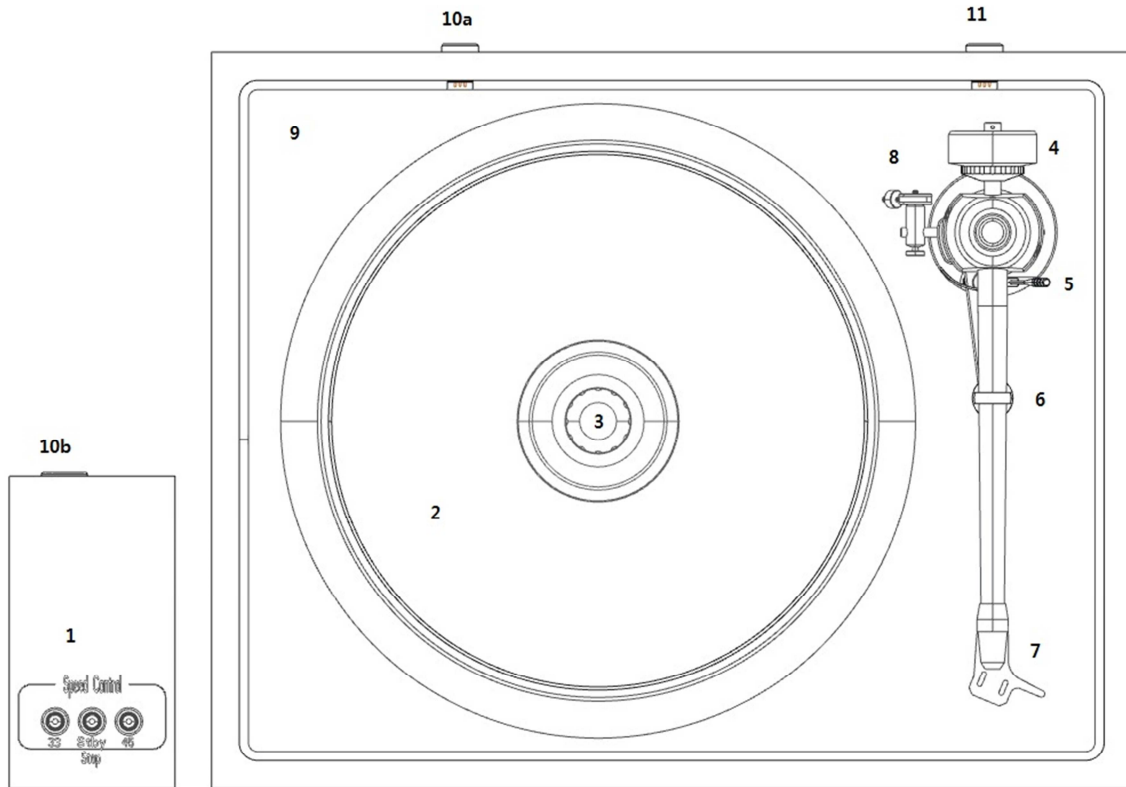

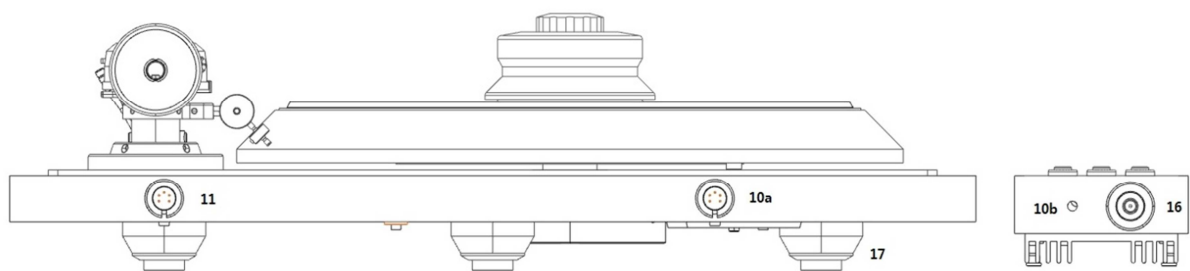

CONTROLS, FEATURES AND CONNECTIONS

1. Control panel with speed control
2. Platter with vinyl on the top
3. Screwable record clamp
4. Tonearm counterweight
5. Tonearm lift lever
6. Tonearm rest position
7. Headshell with finger lift
8. Anti-skating weight
9. Floating chassis
10. (a,b,) Connectors for speed control panel
11. 5-PIN tonearm output
12. Motor with motor pulley
13. Drive belt
14. Sub-platter
15. 3x Transport screws
16. Power supply connector
17. Damped adjustable feet
18. Sub-platter bearing shaft

SETUP

1. Transport screws

For the safe transport of the turntable with unique design where the motor and the tonearm are mounted on a different part of floating chassis are used the transport screws **(15)**.

Remove three transport screw from the carbon part of the chassis before installing the sub-platter **(14)**, the drive belt **(13)** and the platter **(2)**.

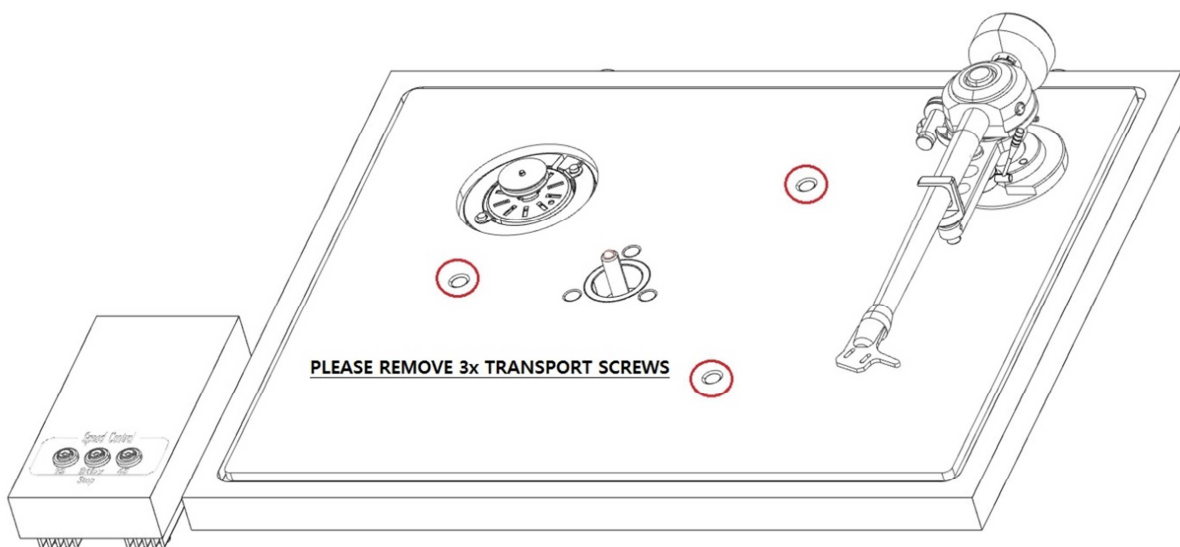

2. Protective covers, sub-platter and drive belt instalation

Main bearing shaft **(18)** and housing in the sub-platter **(14)** are covered by special plastic protective covers. These covers serve as protection against dust and dirt and keeps the bearing shaft and housing sufficiently lubricated. If necessary, lubricate the shaft with grease from the attached accessories. Maximum dose for greasing is **0,5ml**. Deduct the quantity from the scale on supplied syringe with grease.

Remove the protective covers from the main bearing shaft **(18)** and from the sub-platter **(14)**. Install the sub-platter and the drive belt as mentioned on the next pictures.

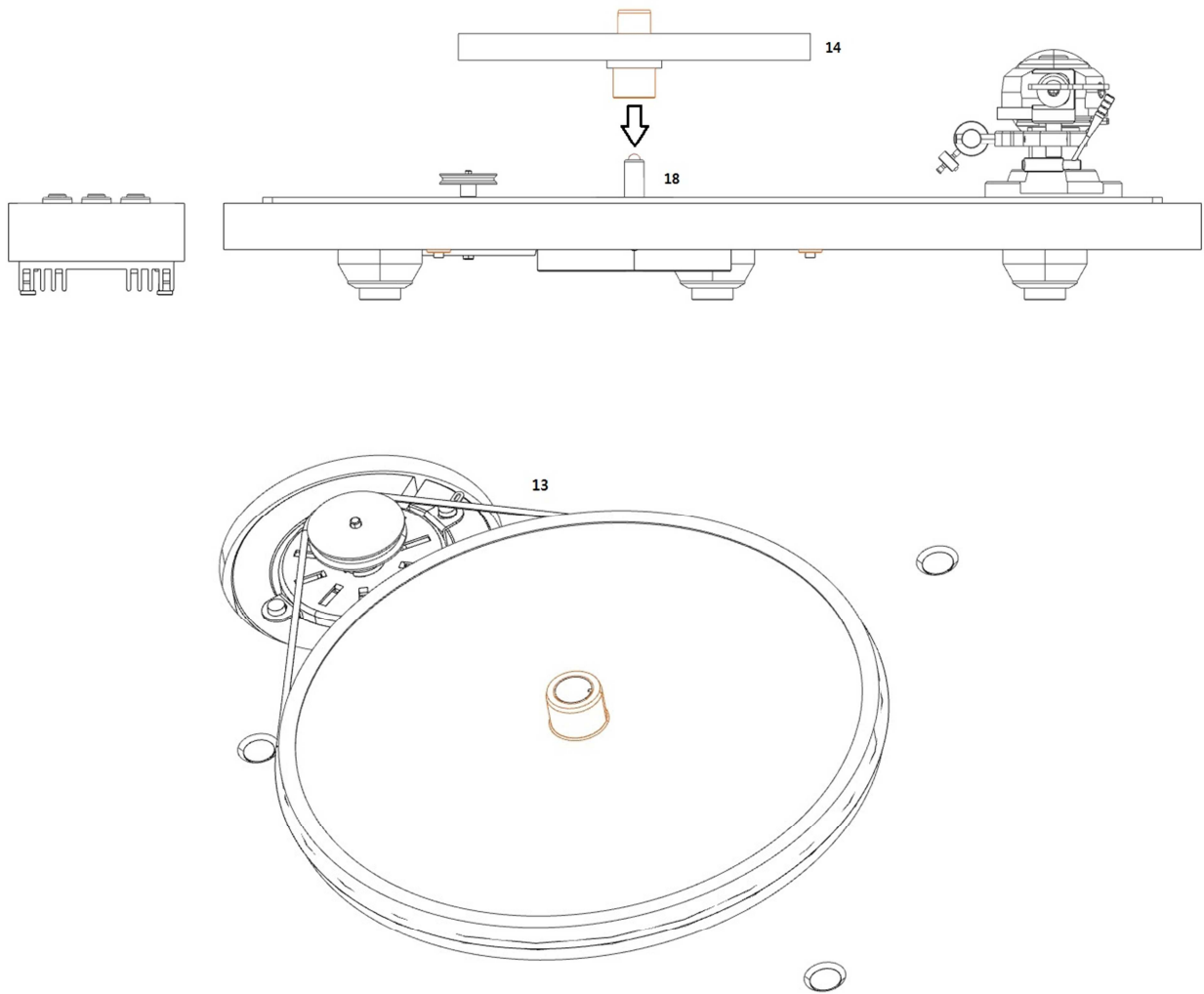

3. Platter instalation

The platter **(2)** has a shaft with thread for screw-able Record Clapm **(3)**. Before installing the platter on the sub-platter, screw the Record Clamp onto the platter.

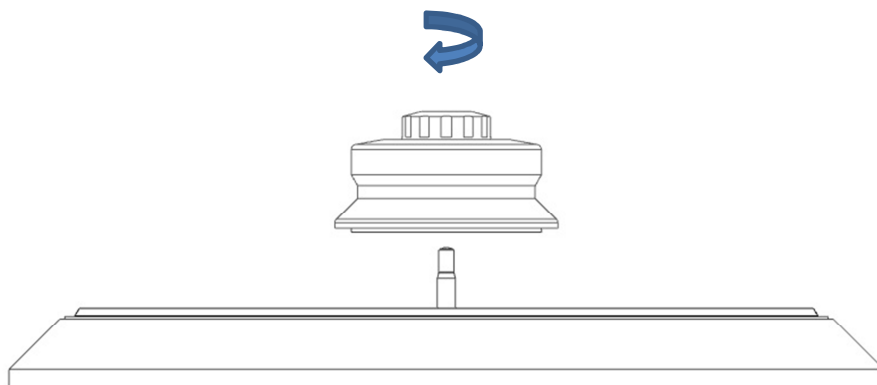

After you successfully installed the Record Clamp on the platter, make sure that the Record Clamp is holding firmly on the platter. Hold the Record Clamp when carefully centering the platter onto the sub-platter.



NO GREASE BETWEEN SUB-PLATTER AND MAIN PLATTER

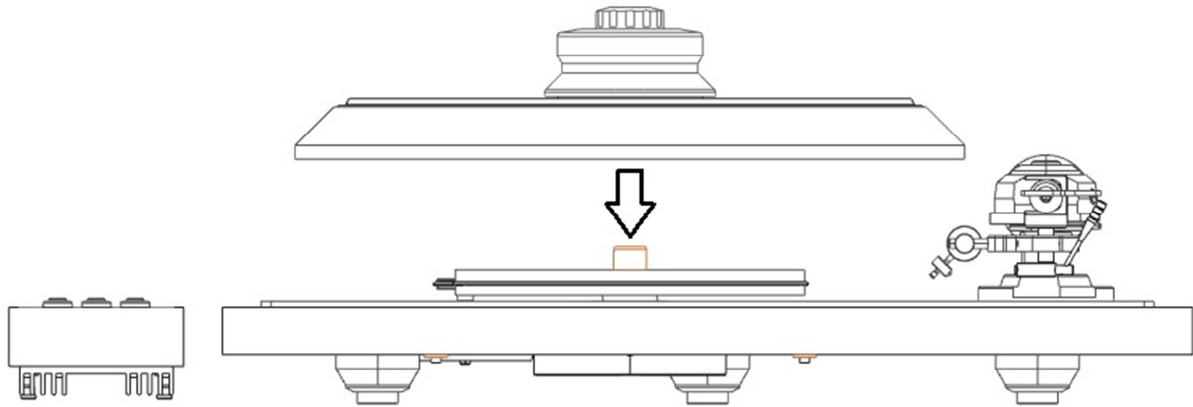

4. Tonearm assembly

The tonearm is a combination of cardan bearings and as a special support is there also a uni pivot tip which is submerged in special vaseline.

Setting of the tonearm will be described in next steps.

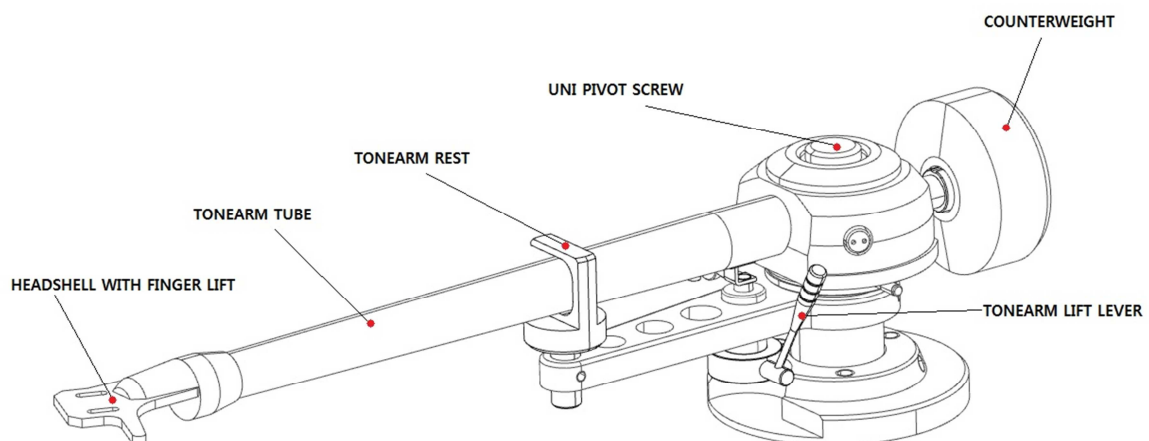

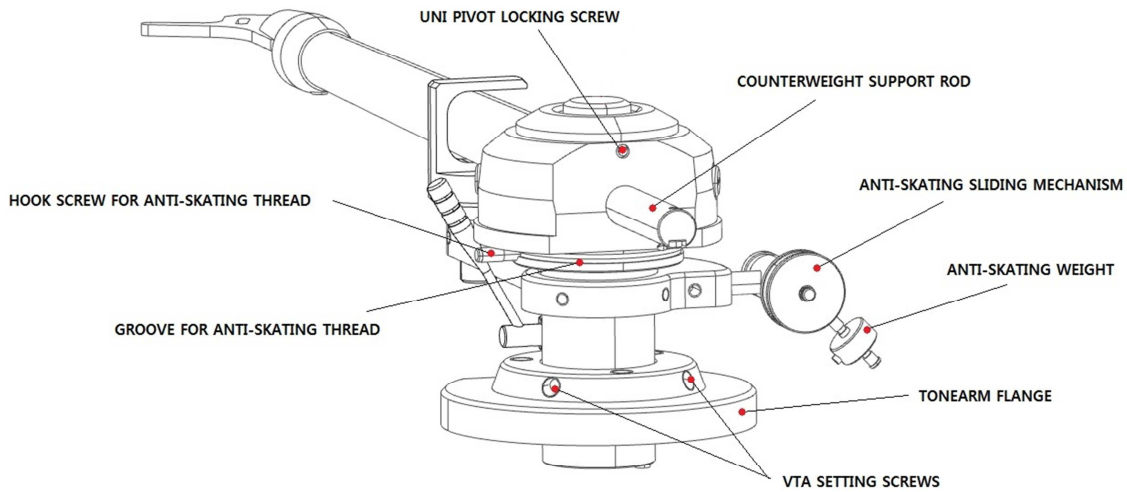

a) Cartridge assembly

Install the cartridge into the aluminium headshell. Install screws that are part of the cartridge box into the oval holes of the headshell and fix it into the cartridge holes from the bottom side of the aluminium headshell.

Connect the cartridge as mentioned below:

- White left channel L+
- Red right channel R+
- Green right channel R-
- Blue left channel L-

For correct position of the cartridge, use the two point cartridge alignment protractor which you find in the accessories.

b) Counterweight assembly

Supplied counterweight has special TPE (thermo plastic elastomer) damping. This counterweight has two separate parts.

First part is counterweight itself and second part is additional insert which allows to balance heavier cartridges.

Counterweight without additional insert can balance cartridges **from 5 to 9g**.

Weight of the counterweight itself is **125g**.

Counterweight with additional insert can balance cartridges **from 8,5 to 13g**.

Weight of the counterweight with additional insert is **142g**.

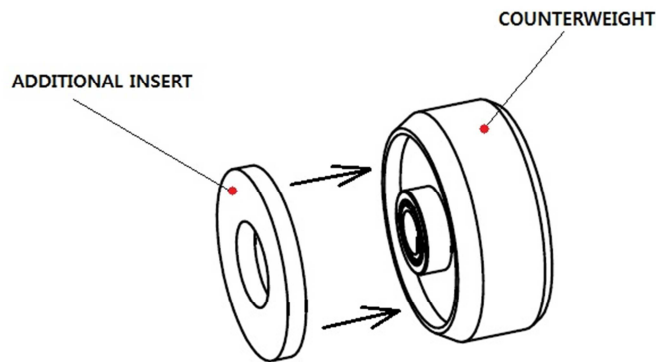

c) Vertical Tracking Force setting (VTF)

Before setting the Vertical Tracing Force, check out the exact weight of your cartridge. Depending on the weight of your cartridge, choose the counterweight with or without additional insert as is mentioned on page 9.

Pushing carefully, turn the counterweight **(4)** onto the rear end of the counterweight support rod. Place the styus pressure gauge onto the platter. To set the required VTF, lower the tonearm lift as mentioned on the picture and place the tip of the stylus on the pressure gauge.

Turning the counterweight counterclockwise (towards to the tonearm) increases the VTF, turning clockwise (away from the tonearm) reduce the VTF.

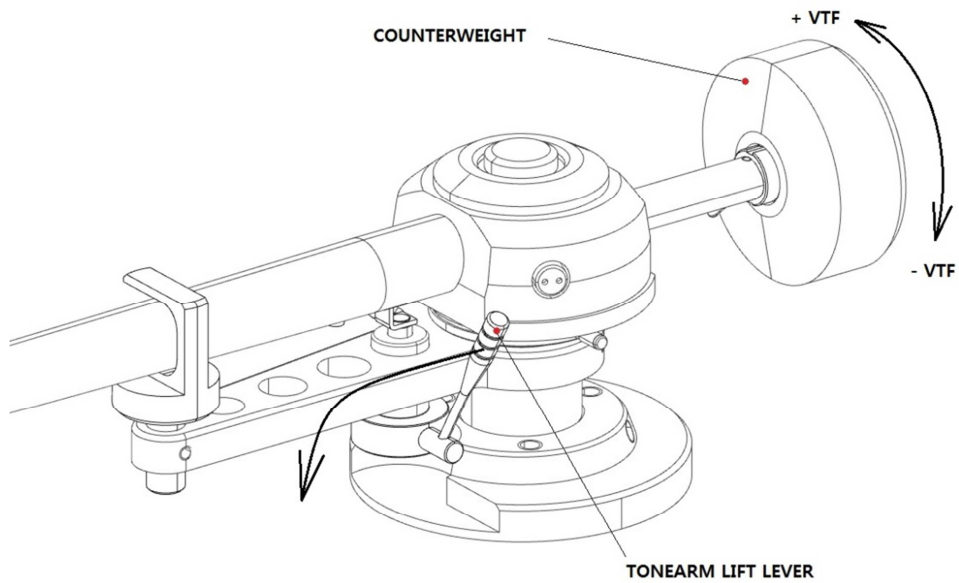

d) Tonearm output connection

Connect the cable from the accessories to the connector which is located on the rear side of the turntable behind the tonearm. Keep the right position of the connector!

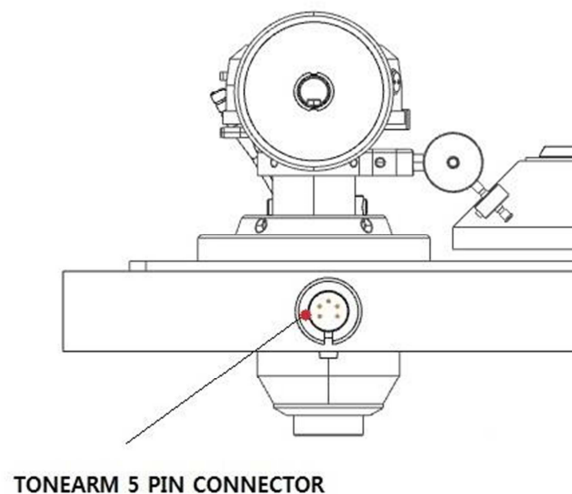

e) Vertical Tracking Angle settings (VTA)

Put a record on the platter. When the needle is lowered into the record groove and the tonearm is not resting on the tonearm rest, the tube of the tonearm should be parallel to the surface of the record. If it is not, loosen both hexagonal screws in the tonearm base just enough to allow vertical movement of the arm pillar without force and slide the arm up or down until it is parallel.

Carefully retighten the hexagon screws without applying excessive force (which would deform the arm pillar).

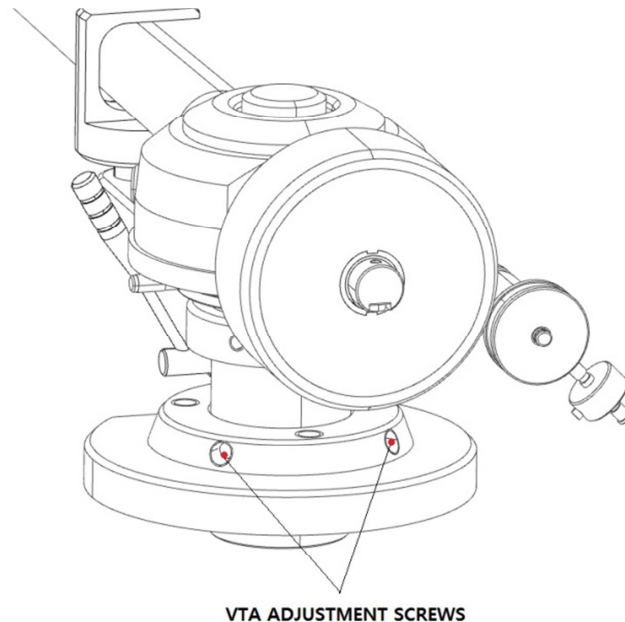

f) Azimuth settings

The cartridge needle must be vertical in the record groove in order to trace the groove wall modulations correctly.

The azimuth is precisely set from the factory. In case that you need to modify this setting, follow instructions below.

Step 1:

Unscrew small UNI PIVOT LOCKING SCREW by 1,5mm hexagonal key from supplied accessories. Then carefully lift the UNI PIVOT cover together with UNI PIVOT screw and place in a safe and clean place.

Step 2:

Unscrew small AZIMUTH SETTING SCREW by 1,5mm hexagonal key from supplied accessories.



NOTE! DO NOT REMOVE THE SCREW COMPLETELY!

Slacken off the screw just enough to be able to revolve the arm tube without applying force and set the azimuth to the correct position. Correct position can be checked from the front view, preferably with needle placed on a mirror which is placed on platter.

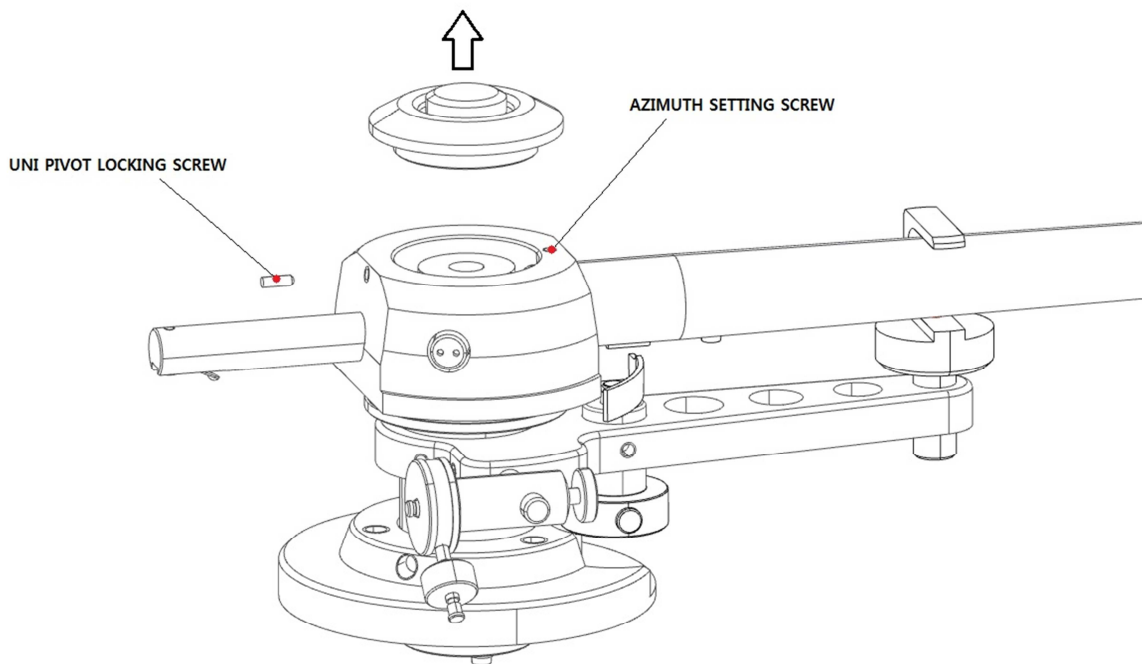

Examples of incorrect azimuth setup:

Too much left angle:

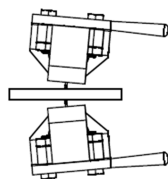

Too much right angle:

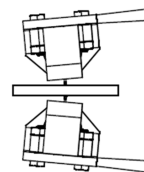

The correct position is 100% perpendicular to the record.

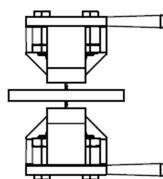

g) Anti-skating assembly and adjustment

Anti-skating mechanism is supplied partially disassembled to avoid damage during transport. For exact installation please follow next steps described below.

Step 1:

Prepare all parts supplied from the accessories bag.

Anti-skating sliding mechanism with anti-skating weight and thread for mounting on the tonearm and anti-skating support rod.

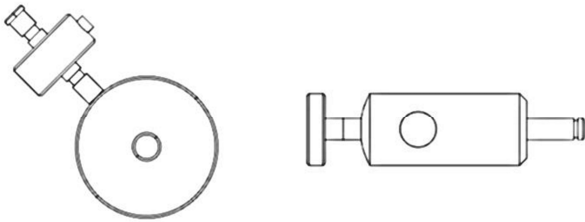

Step 2:

Put the anti-skating support rod in the middle of the shaft which is rigidly mounted on the tonearm as is mentioned on the picture below. Then tighten the screw to prevent movement on the shaft.

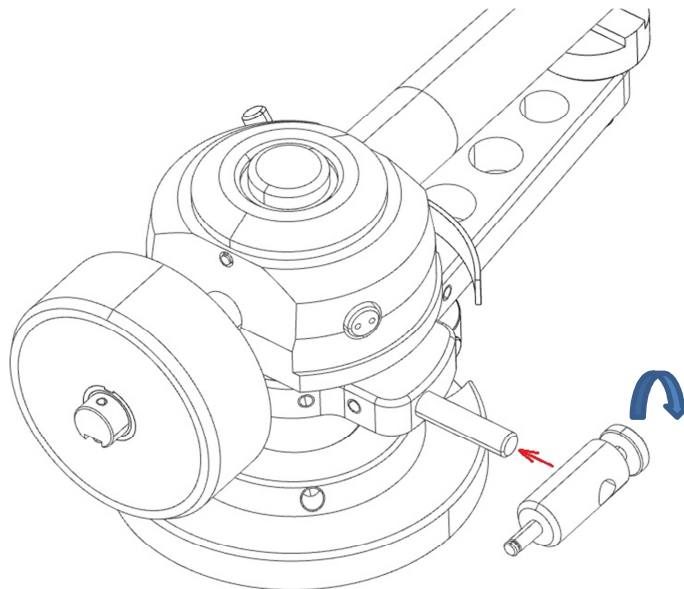

Step 3:

Anti-skating sliding mechanism is supplied with mounted anti-skating weight and also with anti-skating thread. Put the eye of the anti-skating thread onto the hole for HOOK SCREW and screw the HOOK SCREW into the tonearm as is mentioned on the picture below.

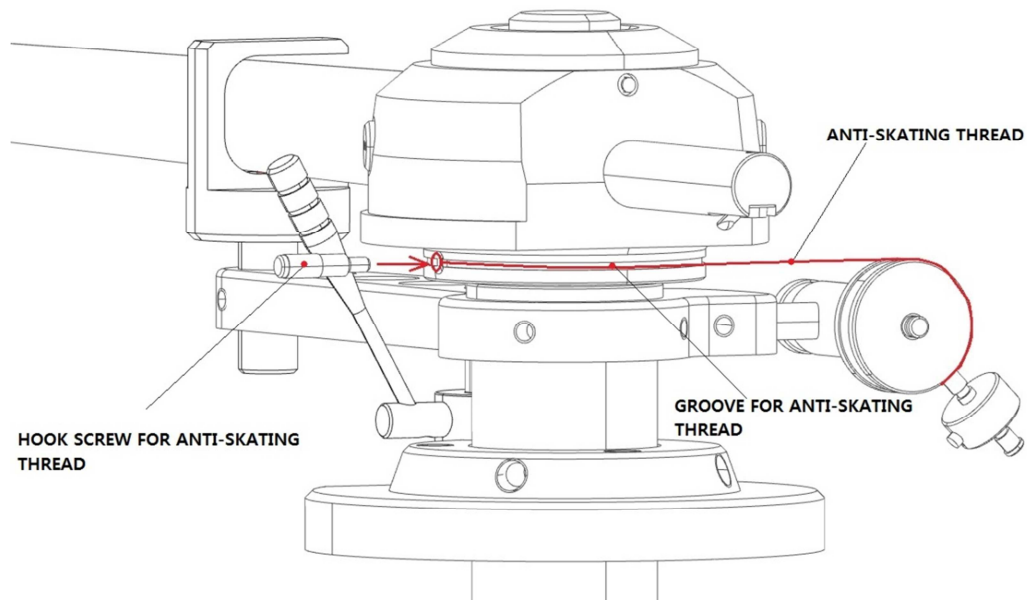

Step 4:

Put the anti-skating mechanism to the end of anti-skating support rod. Anti-skating thread should fit into the groove in the tonearm.



Be careful, there is a danger to rip off thread by tensile force.

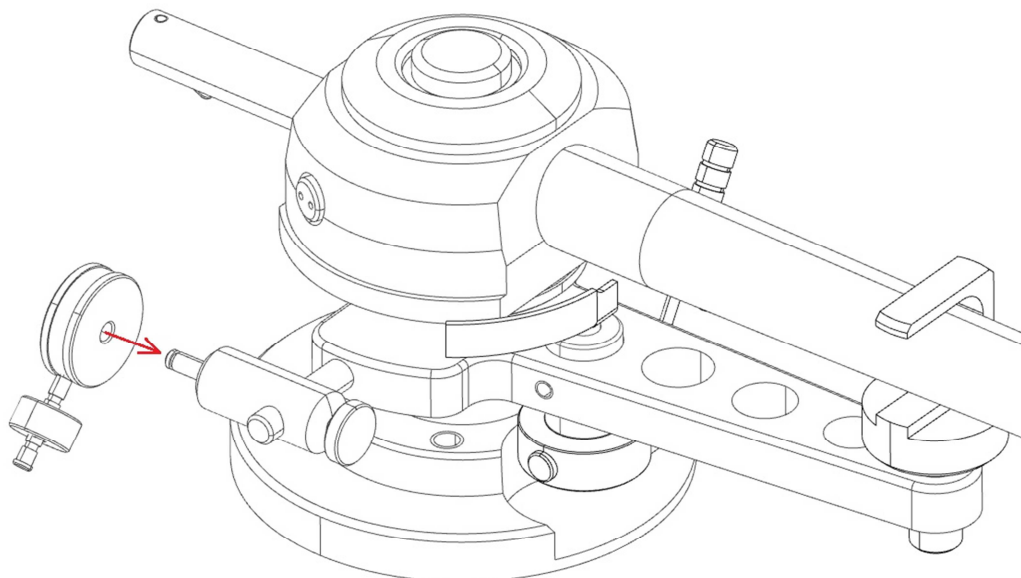

Step 5:

Anti-skating force adjustment:

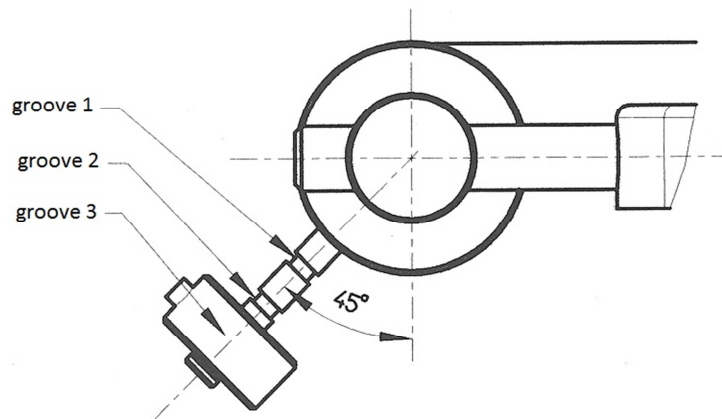

Anti-skating downforce must be adjusted corresponding to the downforce as follows:

<u>Downforce:</u>	<u>Anti-skating groove:</u>
Lower than 13mN	1 st from bearing rings
13 - 18 mN	2 nd from bearing rings
18 - 25mN	3 rd from bearing ring

5. Turntable level position

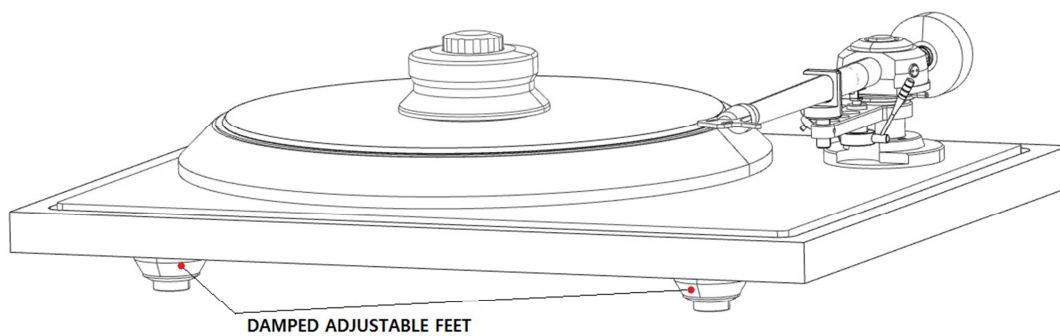

On the turntable are mounted three precision adjustable damped feet for perfect setting of the turntable plane. Put the spirit level on the carbon top plate balance the turntable by screwing / unscrewing the feets . Check the plane from several perspectives.

6. Starting the motor, changing the speed

Control of the turntable is performed by external control panel. Press button with **33 r.p.m.** to start the turntable. For change the speed from **33 r.p.m.** to **45 r.p.m.**, press button with **45 r.p.m.**

To switch turntable back to **STAND BY** mode, please press button **Stby**.

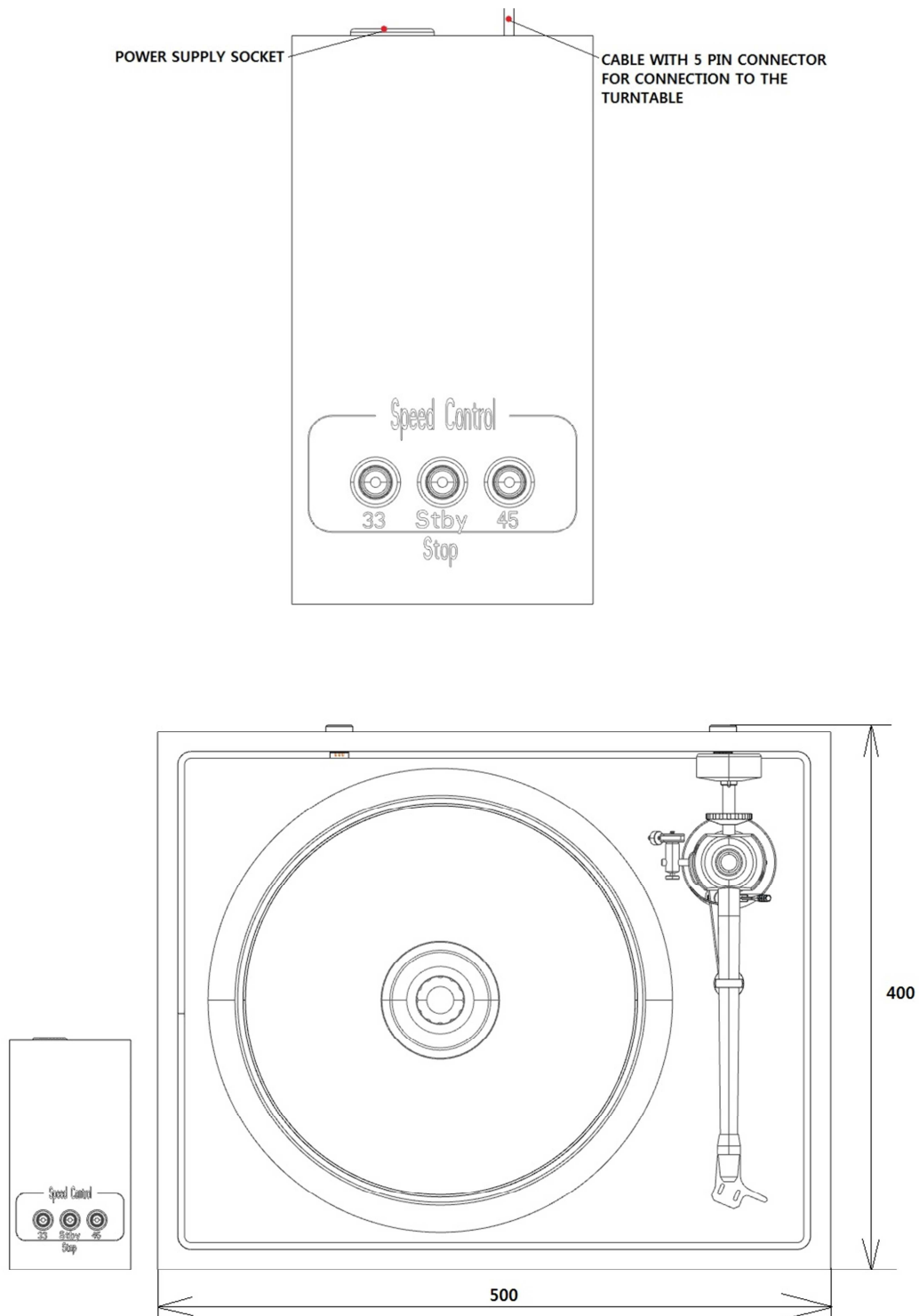

7. Technical Specifications EAT C-Sharp

Model <i>Modell</i>	C-Sharp
Nominal speed <i>Geschwindigkeiten</i>	33/45 rpm , driven by microprocessor, separate control panel, lighted control buttons
Speed Variance <i>Drehzahlabweichung</i>	33rpm: $\pm < 0,08\%$, 45rpm: $\pm < 0,09\%$
Signal to noise <i>Rumpeln</i>	S/N Ratio (mechanical noise): - 40 dB, Signal to noise (electrical noise): -70dB
Downforce range <i>Möglicher Auflagedruck</i>	0 - 30 mN
Supplied counterweights <i>Mitgeliefertes Gegengewichts</i>	without additional insert → for cartridge 5 - 9g (125g) , with additional insert → for cartridge 8,5 - 13g (142g)
Effective tonearm mass <i>Effektive Masse des Tonarmes</i>	16,5g
Effective tonearm length <i>Effektive Länge des tonarmes</i>	254mm
Overhang <i>Überhang</i>	16mm
Power consumption <i>Leistungsaufnahme</i>	8,5 W max/ 0,5W stanby
Voltage <i>Betriebsspannung</i>	Universal swith mode power supply 15V DC/1,6 A, 90-264 V AC, 47 - 63Hz
Dimensions (W x H x D) <i>Masse (B x H x T)</i>	500 x 400 x 115mm without connectors, 500 x 435 x 115mm with connectors in the rear panel
Weight (without box) <i>Gewicht (ohne Verpackung)</i>	13,5kg + 0,5kg Separated control panel

Potential incorrect use and fault conditions

EAT turntables are manufactured to the highest standards and undergo strict quality controls before leaving the factory. Faults that may possibly occur are not necessarily due to material or production faults but can sometimes be caused by incorrect use or unfortunate circumstances. Therefore the following list of common fault symptoms is included.

The platter doesn't turn although the unit is switched on:

The unit is not connected to the mains power supply.

No mains at the socket.

Drive belt is not fitted or has slipped off.

No signal through one or other channel or both channels:

No signal contact from the cartridge to the internal tonearm wiring or from that to the arm lead or from that to the phono box or between that and the amplifier. This could be due to a faulty plug, broken wire or solder joint loose plug/socket connection.

Phono input not selected at amplifier.

Amplifier not switched on.

Amplifier or speakers are defective or muted.

No connection to the loudspeakers.

Strong hum on phono input:

No earth connection from cartridge or arm or arm cable to amplifier, or earth loop.

Distorted or inconsistent sound from one or both channels:

Record player is connected to wrong input of amplifier, or MM/MC switch incorrectly set.

Needle or cantilever damaged.

Wrong r.p.m., drive belt overstretched or dirty, platter bearing without oil, dirty or damaged.

Service

Should you encounter a problem which you are not able to alleviate or identify despite the above informations, please contact your dealer for further advice. Only when the problem cannot be resolved there should the unit be sent to the responsible distributor in your country.

Guarantee repairs will only be effected if the unit is returned correctly packaged. For this reason we recommend keeping the original packaging.

Never return a record player without making sure that it is safely disassembled and correctly packaged in the original packaging according to the supplied diagram. Please remove these parts and pack them separately:

feet, counterweight, platter, cartridge and belt. Fit the cartridge protection cap. Insert the transport lock for the tonearm prior to carefully packaging the record player.

Warranty

The manufacturer accepts no responsibility for damage caused by not adhering to these instructions for use and/or by transportation without the original packaging. Modification or change to any part of the product by unauthorized persons release the manufacturer from any liability over and above the lawful rights of the customer.

EAT European Audio Team is a Registered Trademark
Jozefina Lichtenegger.

This guide was produced by: EAT European Audio Team
Copyright © 2015. All rights reserved.

The information was correct at the time of going to press. The manufacturer reserves the right to make changes to the technical specification without prior notice as deemed necessary to uphold the ongoing process of technical development.